



Meteor Road  
Westcliff On Sea, SS0 8DG

£950 PCM



## Meteor Road

Westcliff On Sea, SS0 8DG

Nestled on Meteor Road in the charming area of Westcliff On Sea, this second floor flat presents an excellent opportunity for those seeking a modern and convenient living space. The property boasts a well-proportioned lounge/diner, the double bedroom offers a comfortable retreat, while the contemporary kitchen and bathroom provides all the modern amenities.

Conveniently located, this flat is just a short stroll from the mainline station, making commuting a breeze. Additionally, the vibrant Hamlet Court Road is nearby, offering a delightful array of shops, bars, and restaurants to explore.

This property is ideal for individuals or couples looking for a stylish home in a lively community. We strongly advise an early viewing to fully appreciate what this flat has to offer. Don't miss out on the chance to make this lovely space your own.





Entrance Hallway

Open Plan Lounge/Diner  
16'08" x 10'08" (5.08 x  
3.25)

Kitchen Area  
11'06" x 7'11" (3.51 x 2.41)

Master Bedroom  
12'08" x 11'10" (3.86 x  
3.61)

Family Bathroom

## Floor Plan

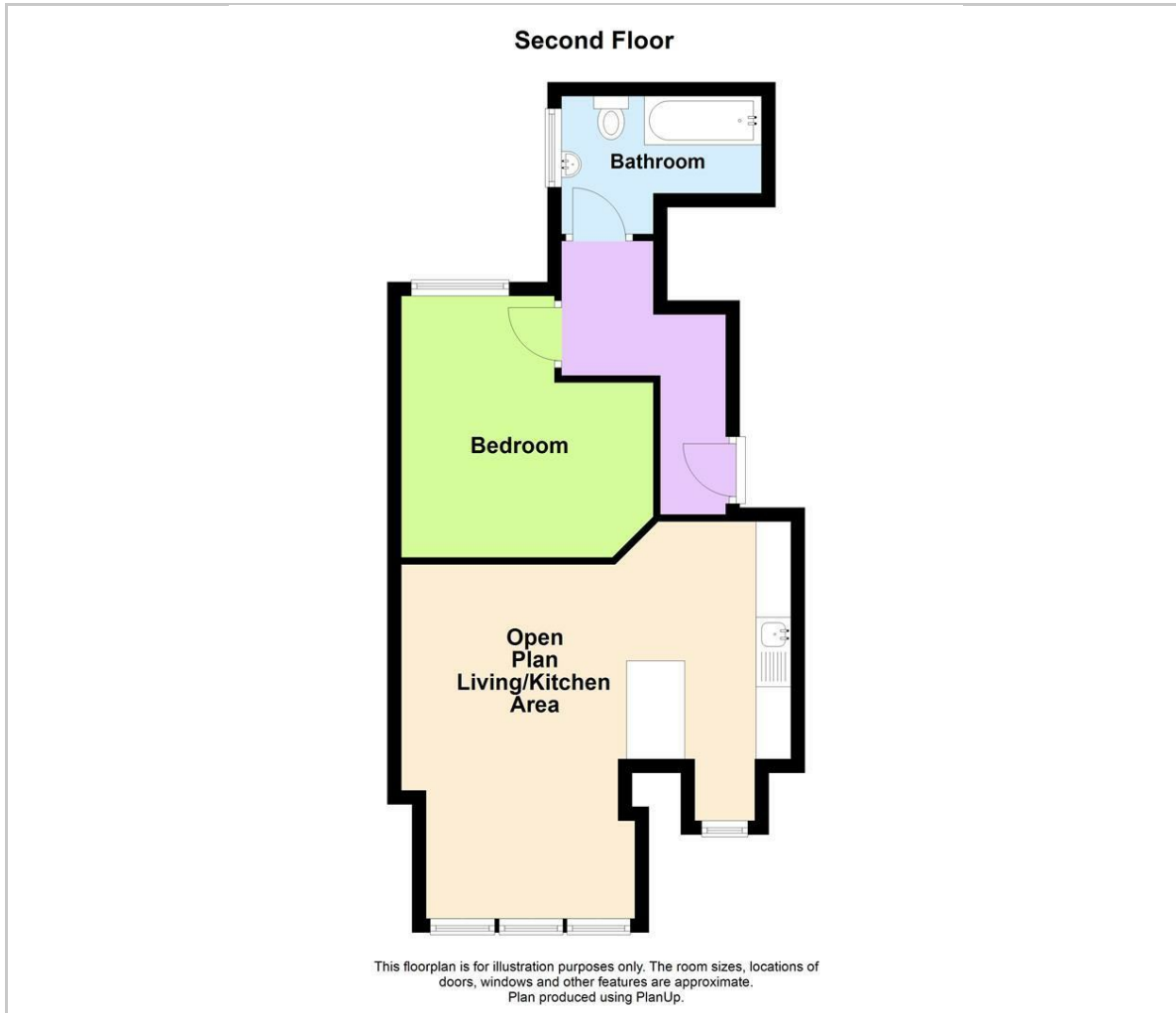

## Area Map



## Energy Efficiency Graph

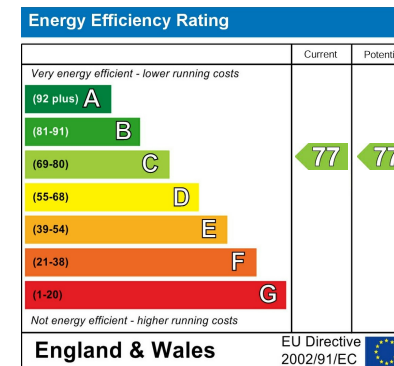

Please contact our office on 01702710555 if you wish to arrange a viewing appointment for this property or require further information.

These particulars, whilst believed to be accurate are set out as a general outline only for guidance and do not constitute any part of an offer or contract. Intending purchasers should not rely on them as statements of representation of fact, but must satisfy themselves by inspection or otherwise as to their accuracy. No person in this firm's employment has the authority to make or give any representation or warranty in respect of the property.

